



DALI EM Option

Luminaires with part numbers having -DALI are fitted with DALI modules (nodes) that facilitate connection and integration to 3rd Party Lighting Control Systems. Before installing the -DALI luminaire, please confirm that the Lighting Control System has the capability to monitor DALI Emergency Luminaires. The -DALI fitting will be addressed and configured into the control system by the Lighting Control System Commissioning Technicians and not Clevertronics.

State	LED Operation
Commissioned/ Un-commissioned	LED on Solid (Green)
Emergency Light Test in progress	LED flashes at 1s On (Yellow) & 1s Off
"IDENTIFY COMMAND"	Fitting goes into emergency mode for 10 seconds

A 2-way "figure 8" cable and terminal block facilitates the connection to the DALI network. DALI connections are marked as Da Da.

To confirm operation of the fitting the Lighting Control System can only use the status query type command. To "test" the sign this status query will need to be synchronised with the formal test of the UPS from its battery source. The sign will report a fault if the LED lamp bar is not illuminated.

DO NOT run a Start Function Test or Start Duration Test command. If either of these is run, the fitting will go into test mode and the fitting will switch off as it will be internally disconnected from main power and there is no battery so the LED lamp won't run – the unit will report a failed test. This condition cannot be rectified, and the fitting will report this forever as it can never pass a test of this type.

UPS Wiring and Connecting arrangements

Note: Change-over contacts shown in the de-energized state

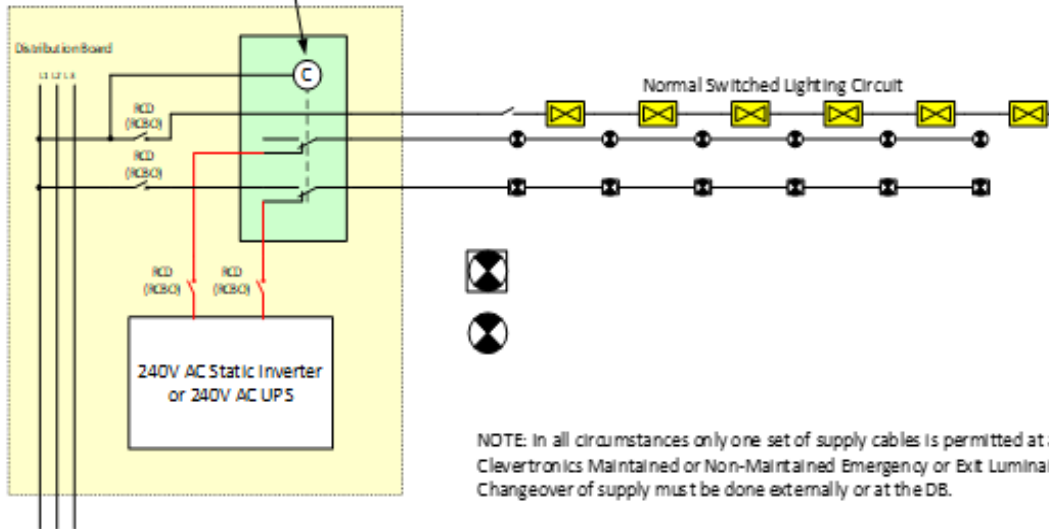

NOTE: In all circumstances only one set of supply cables is permitted at a Clevertronics Maintained or Non-Maintained Emergency or Exit Luminaire. Changeover of supply must be done externally or at the DB.

Note: Not suitable for connection a Zoneworks or Clever-test system.

Note: 110V DC is not supported

L10™ LIFELIGHT PRO Surface Mount Emergency Luminaire

Installation & Maintenance Instruction Leaflet



Victoria (Head Office & Manufacturing)

Website: www.clevertronics.com.au

Email: info@clevertronics.com.au

Phone: +61 3 9559 2700

Fax: +61 3 9559 2799

New South Wales

Phone: +61 2 8805 6400

Fax: +61 2 8805 6444

Queensland

Phone: +61 7 3442 9700

Fax: +61 7 3442 9777

South Australia/Northern Territory

Phone: +61 8 8301 8800

Fax: +61 8 8351 8286

Western Australia

Phone: +61 8 9207 0000

Fax: +61 8 9207 0088

New Zealand

Phone: +64 800 548 448

Designed in Australia to comply with the requirements of AS2293.3: 2005 and AS/NZS CISPR15: 2017

Models: LLIFEx-PRO-SM-UPS-yy

Testing:

Manual Test xx = Blank

DALI xx = DALI

Options:

yy = BLK Colour, Black

x = M Maintained

Spare Parts:

8003081 PCA: LLPRO HEAD Alum #CT10640-D4 - GW CSHPM

8002921 PCA: CCF-Pro #CT10142-L9

Important:

It is illegal for anyone, except for a licensed electrician to install or maintain this product. Before installation, ensure that the electricity supply has been switched off and isolated. Installation must be carried out in accordance with the relevant Australian and International Standards.

Installation:

The LLIFEx-PRO-SM-UPS is a Surface Mount (SM) fitting that can be attached directly to any solid surface (use appropriate fixings to suit the mounting surface). Please follow the steps below to install the LLIFEx-PRO-SM-UPS:

- Remove the Lid from the Base by using a flat screwdriver to release the snap fits (see below)
- Cut/Drill out Cable Entry points (see image below)
- Drill out the required fixing holes on the Base (see image below)
- Mark holes on mounting surface (use drilled out holes on the Base as a template)
- Mount Base using appropriate fixings to ensure a secure installation (pre-drill holes if required)
- Insert Mains Cables through Cable Entry
- Terminate the Mains Cables into terminal block. Ensure Active, A & Neutral, N wires are connected as per Terminal Block Label.
- Re-attach Lid Assembly, ensuring to align Mains Connector Pins into Terminal Block
- The luminaire should be positioned so that prolonged staring into the luminaire at a distance closer than 350mm is not expected.

Note:

This luminaire (with reinforced insulation between control/LED terminal and AC supply) contains non-user replaceable light source - to be replaced (if required, refer installation instructions) by Clevertronics service personnel/agents or a registered electrician.

Networking:

When installing the product on a monitored network, (DALI) simply insert the relevant Smart Node PCA.

Dimensions:

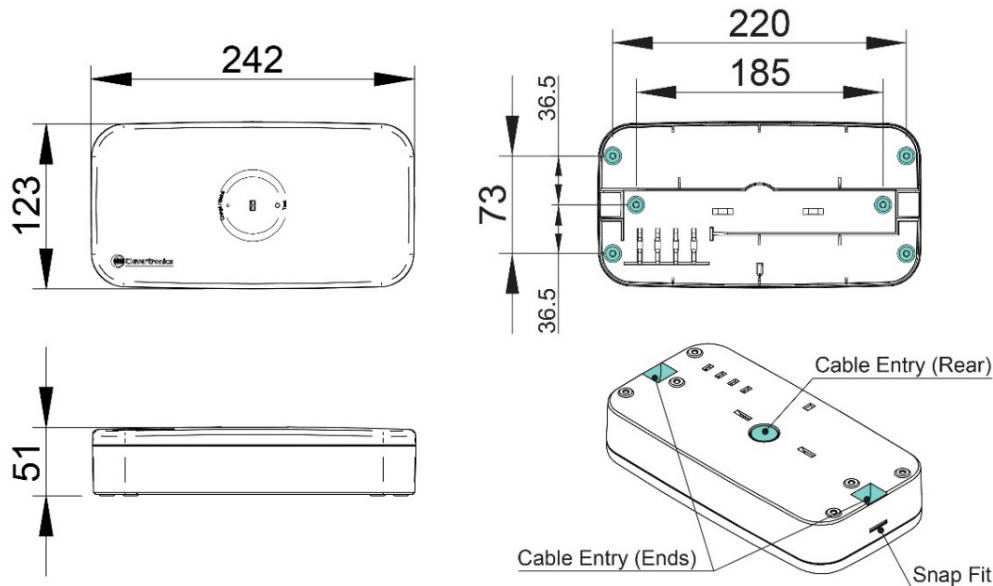

Lid Removal:

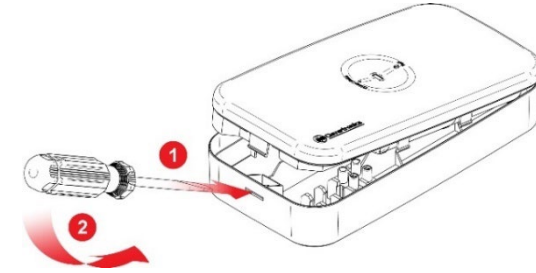

Testing:

Once connected to the 240V mains supply, ensure the UPS unit has been allowed to charge. Conduct the following tests:

- For the first test, the lamp must remain illuminated for at least 2 hours after disconnection from the mains supply with the UPS running from the battery.
- Subsequent tests require the unit to illuminate for at least 90 minutes. The results of all tests are required to be recorded in a service logbook, which is to be kept on-site at all times. If the unit fails to remain illuminated for the requisite time, remedial action must be taken to repair the situation and once completed, the unit must pass a subsequent test. For more specific information, please refer to the current edition of the AS 2293.3 Standard.

Trouble Shooting:

Below are a list of common problems and their possible causes.

Fault: The Status LED indicator and main lamp is not illuminated.

Check: A.C. is connected and is turned on.
Test Switch for damage.

Fault: Lamp does not illuminate in emergency mode.

Check: A.C. is connected.
Lamp is correctly inserted.
UPS battery condition

Warranty:

For Product Warranty information and Terms and Conditions of Sales please refer to our website <http://clevertronics.com.au/terms-conditions-sale-australia-nz/>